

# THE SAGE

1,185 SQ.FT.

**colours  
of seton**  
TOWNHOMES

202, 550 Seton Circle SE

2 Bedrooms ▲ 2½ Bathrooms ▲ Tandem Garage

FEBRUARY POSSESSION



## OPTIONS INCLUDED IN THIS HOME

- Close proximity to local shopping amenities
- Upgraded semi built-in appliances in kitchen
- Quartz countertops
- Electric fireplace in great room
- Dual bedrooms with separate ensuites & walk-in closets
- Zebra blinds
- A/C rough-ins included
- Gas line to deck

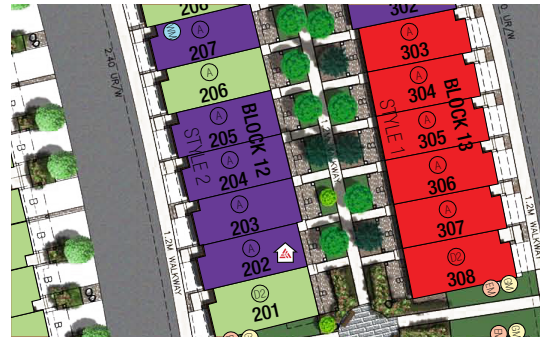

*Plus*  
RECEIVE YOUR OWN  
TRICO RED CARD



AND ENJOY INCREDIBLE ONGOING SAVINGS AND  
REWARDS FROM OUR PARTNERS AND RETAILERS

## VISIT OUR SHOWHOME

247 Seton Grove SE  
Calgary AB

Contact Jessica Sorrell  
CALL: 825.540.1509  
EMAIL: jessicasorrell@tricohomes.com



SHOWHOME THE SAGE

**Showhome hours:**  
MON - THURS: 2 - 8PM  
FRI: Closed  
SAT - SUN: 12 - 5PM



[tricohomes.com](http://tricohomes.com)

**BUILDING IN 31 COMMUNITIES:**  
FRONT-GARAGE HOMES | LANED HOMES | DUPLEXES | TOWNHOMES | CONDOS

# THE SAGE

1,185 SQ.FT.

**colours  
of seton**  
TOWNHOMES

202, 550 Seton Circle SE

2 Bedrooms ▲ 2½ Bathrooms ▲ Tandem Garage

FEBRUARY POSSESSION

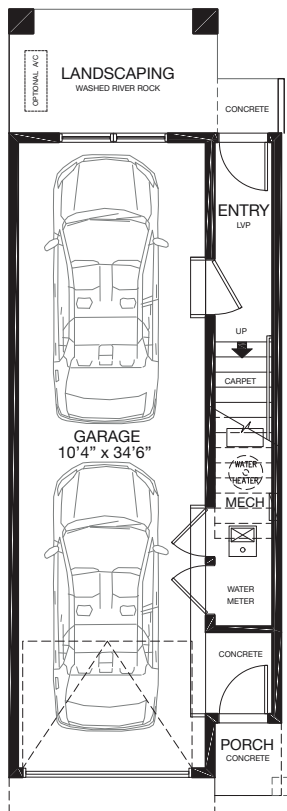

**ENTRY**  
44 SQ.FT

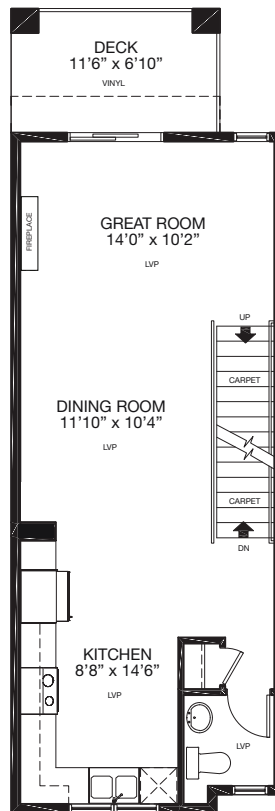

**MAIN**  
559 SQ.FT

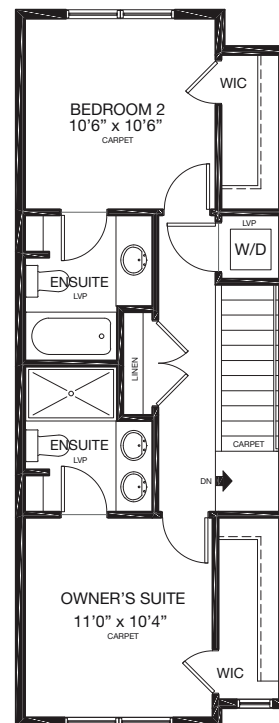

**UPPER**  
582 SQ.FT



Platinum member  
2004 - 2025

Top-rated  
Homebuilder



4.4 ★★★★★



[tricohomes.com](http://tricohomes.com)

Renderings are artist's conceptions only and vary by community and lot selection. Prices, floorplans, specifications and dimensions are approximate and are subject to change without notice. E.&OE. ® All rights reserved, including the right if reproduction in the whole or in part without the permission of Trico Homes. Plan updated January 28, 2026

**BUILDING IN 31 COMMUNITIES:**  
FRONT-GARAGE HOMES | LANED HOMES | DUPLEXES | TOWNHOMES | CONDOS